

K-1

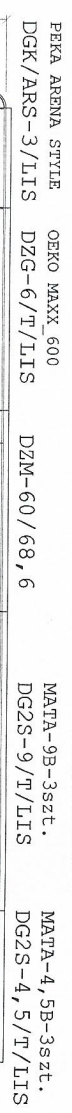

- 2 C7S500RS1/SW-M
- 2 C7S500RS2/SW-M
- 2 C7S500RS3/SW-M-2szt.
- 2 C7F400RSP/SW-M-3szt.

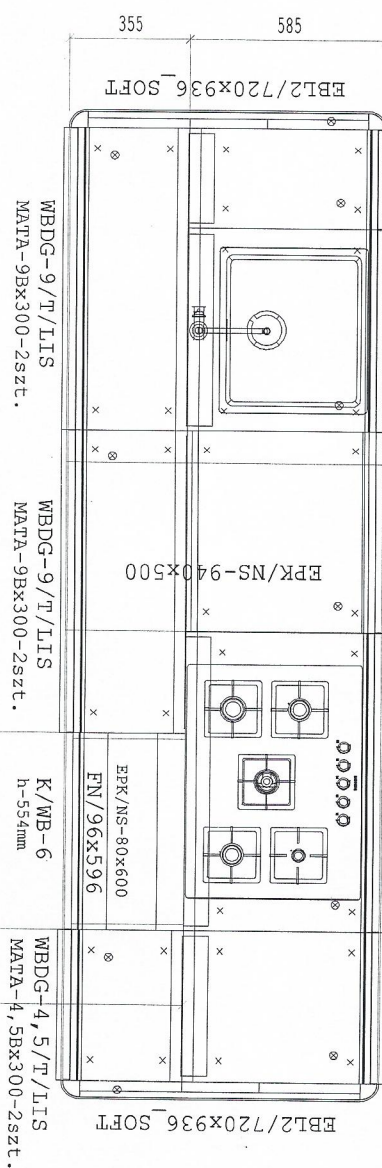

OKTAWIA LISTWOWA 161-szary połysk
 korpus: U-112 POPIEL
 szuflady: antaro białe
 uchwyty: LK aluminium
 cokol: h-150mm LCL-161-szary połysk
 bufet: gr.36mm 441-dąb złoty-termo struktura
 blat: we własnym zakresie

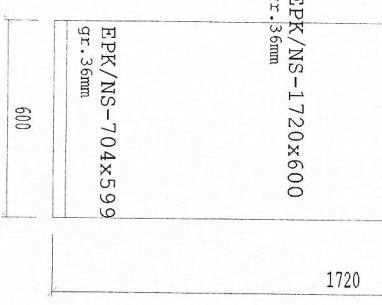

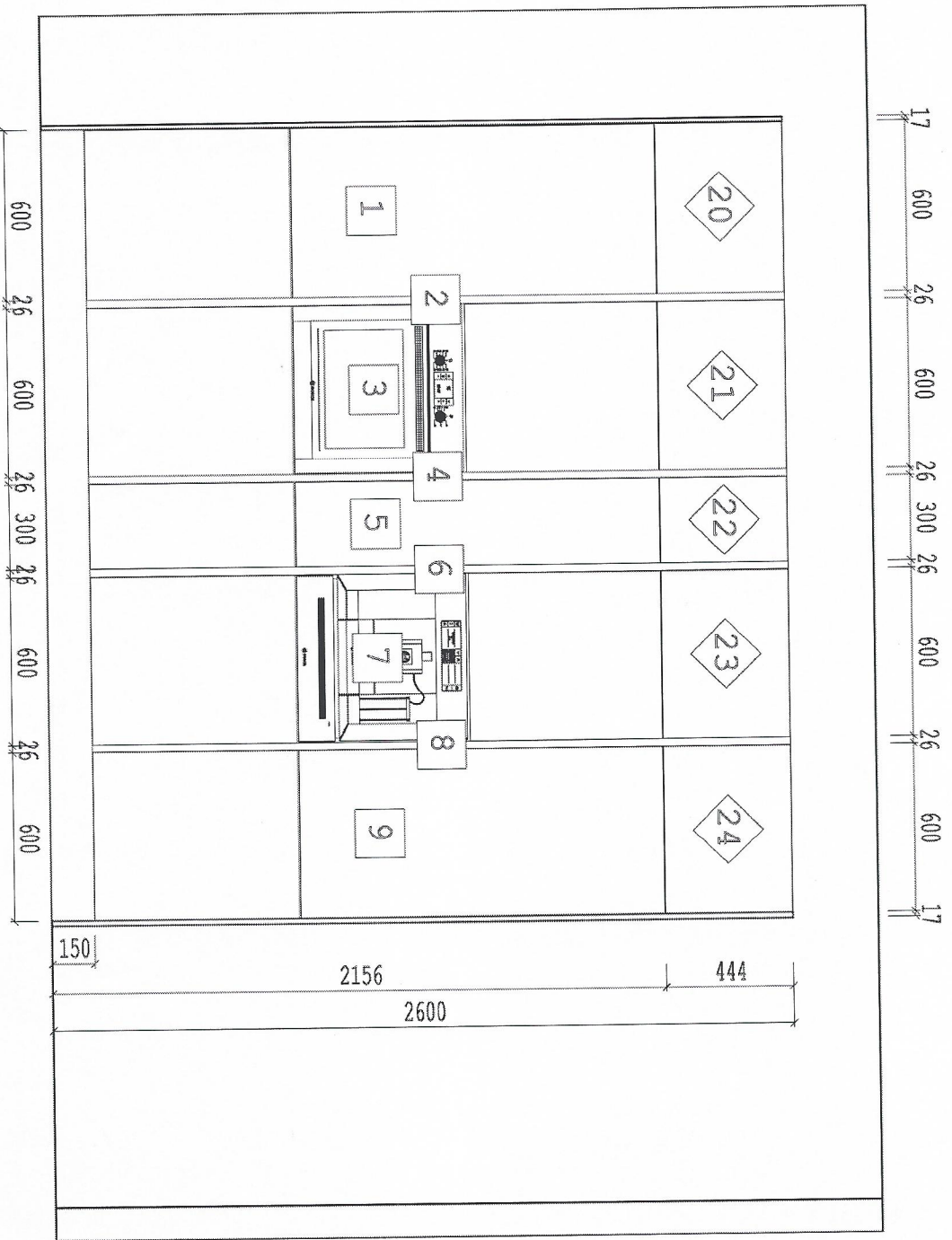

Nr	Nazwa	Typowa	Wymiary	Poziom
1	HL_2Z_LIS	T	600x580x2006	150
2	LKP010/C_2006-580-S	NR	26x580x2450	150
3	HP-6_LIS	T	600x580x2006	150
4	LKP010/C_2006-580-S	NR	26x580x2450	150
5	HD_3_LIS	T	300x580x2006	150
6	LKP010/C_2006-580-S	NR	26x580x2450	150
7	HP-6_LIS	T	600x580x2006	150
8	LKP010/C_2006-580-S	NR	26x580x2450	150
9	H/2-6_LIS	T	600x580x2006	150
20	PAMW/2-6	NR	600x350x444,51	2600
21	PAMW/2-6	NR	600x350x444,51	2600
22	PAMW/2-4	NR	300x350x444,51	2600
23	PAMW/2-6	NR	600x350x444,51	2600
24	PAMW/2-6	NR	600x350x444,51	2600

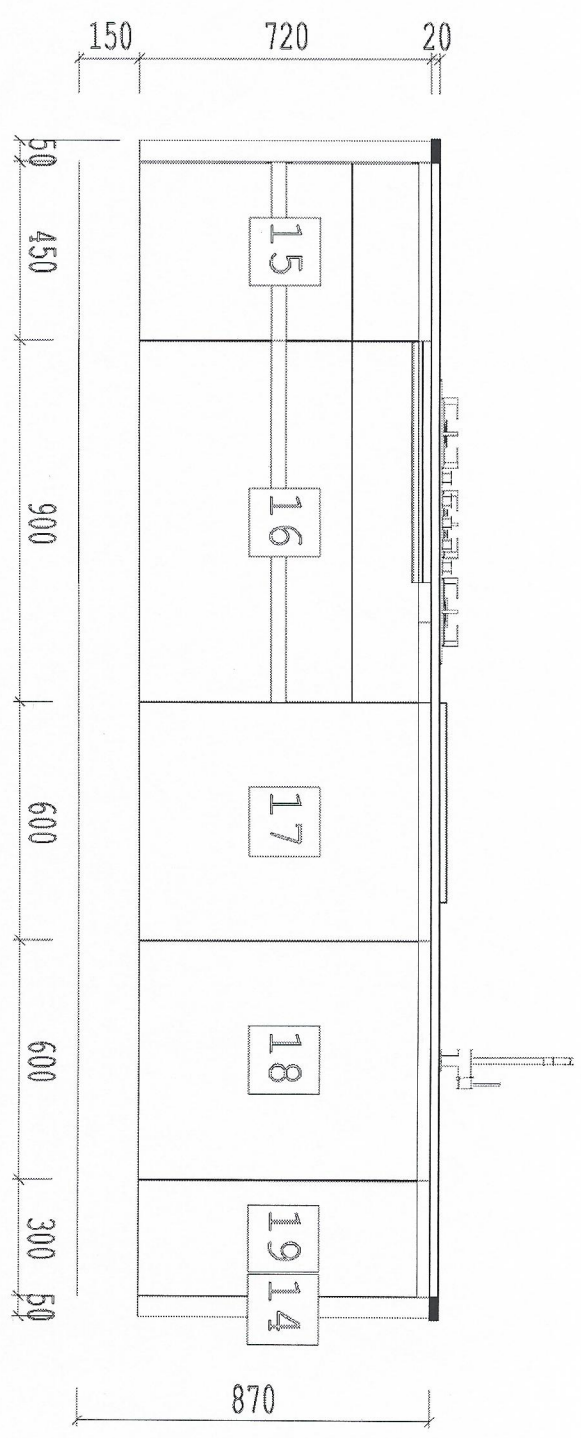
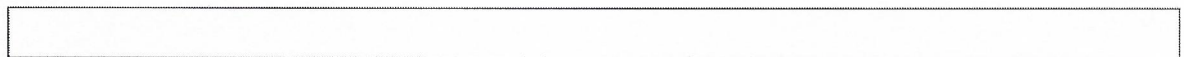

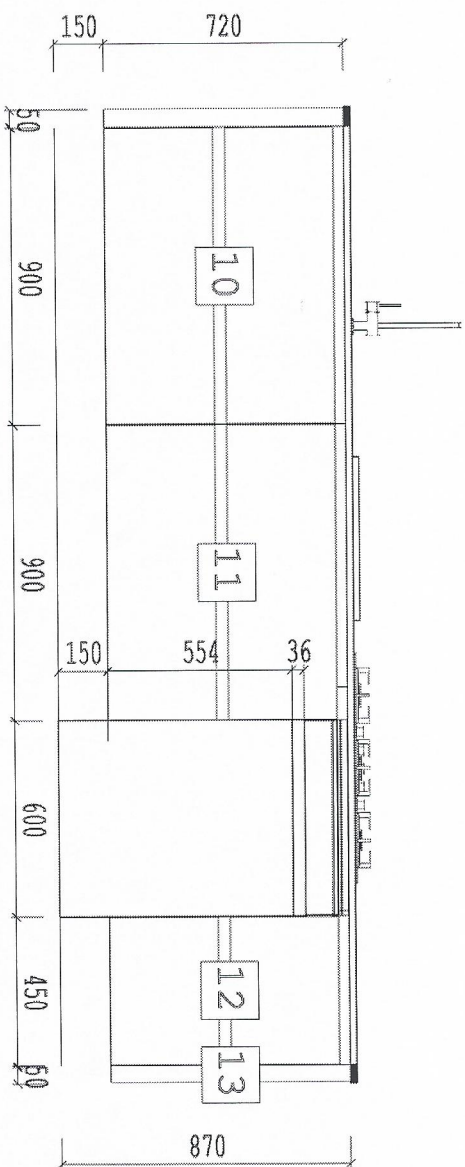

Nr	Nazwa	Typowa	Wymiary	Poziom
10	WBDC-9T/LIS	T	900x350x720	150
11	WBDC-9T/LIS	T	900x350x720	150
12	WBDC-4.5T/LIS	T	450x350x720	150
13	EBL2720x836_SOFT	T	50x936x720	150

